

SANS APPROVED

Cautionary and Regulatory signs



STOP



STOP AHEAD



SLOW



DIRECTION ARROW



BRIDGE HAZARD MARKERS
LEFT RIGHT



RAILROAD CROSSING



TRAIL ENTRY



USE AT OWN RISK



TRAIL ENDS



TRAIL CLOSED

INTERSECTIONS & STOPS

STOP AHEAD

Place 100m to 120m before any stop sign.

If two stop signs are less than 100m apart then a second stop ahead is not required if an unobstructed sightline exists between the two.

STOP

For use at all intersections where other motorized vehicle use occurs, including driveways. No other signs mounted at the same location as the stop sign. No signs on the reverse.

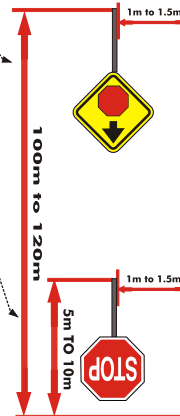

TRAIL ENTRY SIGNS

Sign advises riders of no trespassing on private property without a permit. Erected at entrance to trail well off groomed portion of the trail

INFORMATION SIGNS

Any sign not shown in this guide is to be considered an information sign. No information sign is to have a primary background of red or yellow. All information signs are to be erected well off the groomed portion of the trail and cannot be in the direct sight line of SANS approved cautionary and regulatory signage.



PRESCRIBED TRAIL SIGNS

SANS approved cautionary and regulatory signage installed at every intersection with another trail, highway, railway or another crossing.

Every 5km if no intersection.

USE AT YOUR OWN RISK

To be installed on the right hand side of the trail at all trail entrance points & road crossings, 20 to 30m from traveled portion of the intersection. No other signs to be mounted at the same location.

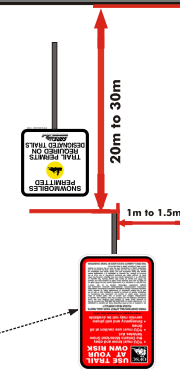

GENERAL SIGN INSTRUCTIONS

- ★ SANS approved cautionary and regulatory signs take precedent over all other signs.
- ★ NO sign shall interfere with the sight lines of SANS approved cautionary and regulatory signs.
- ★ Signs 1.25m to 2m above ground and 1m to 1.5m to the right of the trail.
- ★ SANS approved cautionary and regulatory signs are to be mounted ONE per post with NO signs mounted on the REVERSE side.
- ★ Trees or other natural locations to be used ONLY when a post is NOT an option and location is CLEARLY visible to the trail
- ★ SANS sign guidelines apply unless regulated by law.

SLOW SIGNS

Slow signs are mounted to give advanced warning of potential hazards and are required to be installed 100m to 120m before all hazards such as sharp turns, bridges etc.

No signs between the sign and the hazard if less than 100m. Between hazards a second slow is not needed if unobstructed view between hazards.

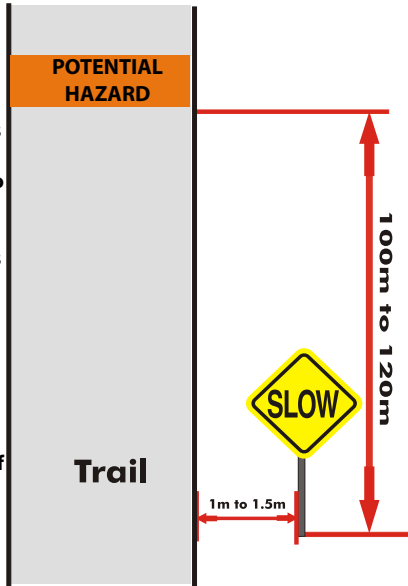

BRIDGE HAZARD MARKERS

Mount on posts above the bridge surface on bridge abutment and below any mandated bridge weight signs.

NOTE: this drawing shows only one side coming at the bridge. The opposite side is to be signed this same way.

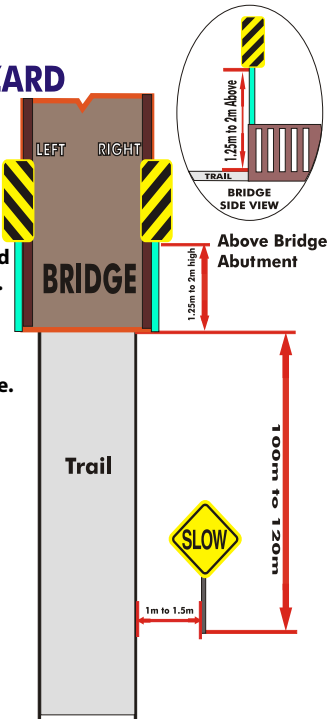

Note: drawings are simulated and not to scale

DIRECTIONAL ARROW

Use to mark the direction of a curve where additional guidance is required. Only one sign shall be used mounted in a horizontal position (as shown) at the apex of the corner in a location that is visible to the approaching operator.

Directional arrow sign is intended for use in curves only and may not be used for any other purpose. Install a slow sign 100m to 120m before the directional arrow sign.

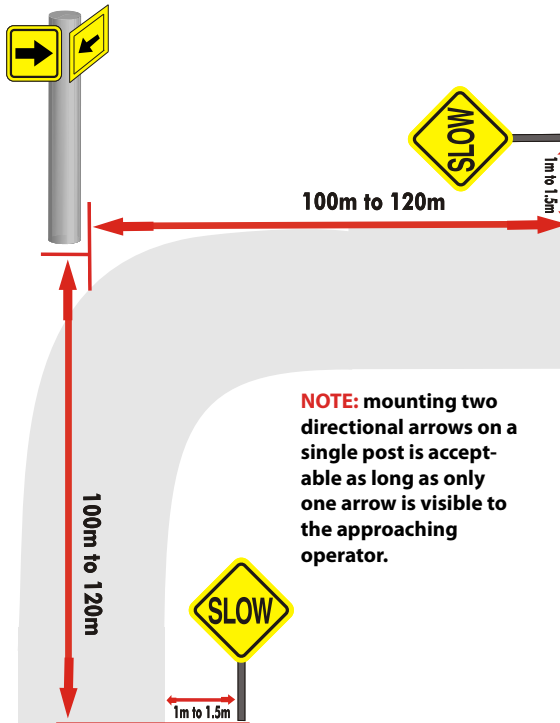
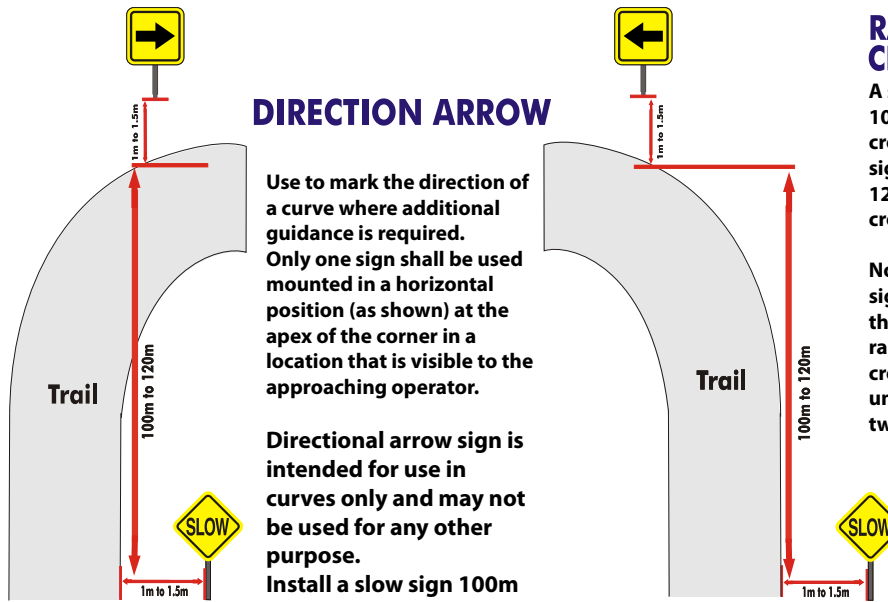

NOTE: mounting two directional arrows on a single post is acceptable as long as only one arrow is visible to the approaching operator.

Note: drawings are simulated and not to scale

RAILROAD CROSSING SIGNS

A stop sign will be placed 5 to 10m prior to the railroad crossing. Railroad crossing sign to be installed 100 to 120m prior to railroad crossing.

No signs between the crossing sign and the stop sign if less than 120m between two railway crossings, a second crossing sign is not needed if unobstructed view between the two crossings.

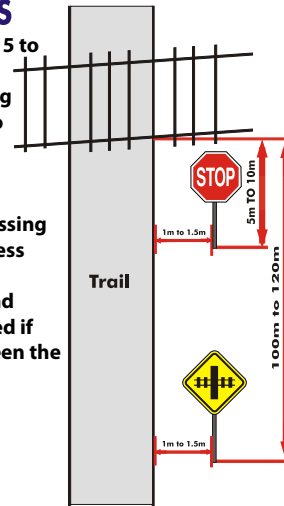

TRAIL CLOSED

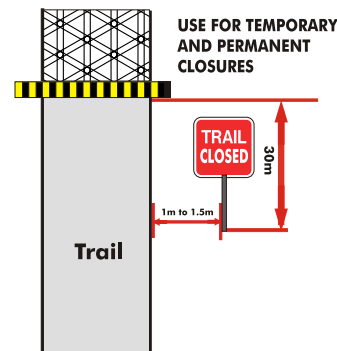

TRAIL ENDS

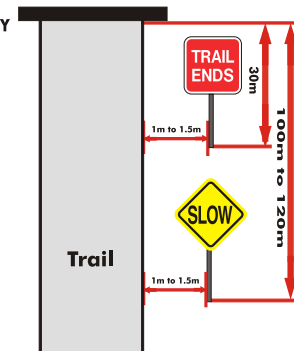

FOR SANS INTERNAL USE ONLY

SIGN GUIDE

DRAFT: February 2013

GENERAL SIGN INSTRUCTIONS

- Regulatory and cautionary signs take precedent over all other signs.
- No sign shall interfere with the sight line of regulatory and cautionary signs.
- Signs are to be mounted 1.25 m to 2 m ABOVE ground and 1 m to 1.5 m to the right of the trail.
- Sign are to be mounted ONE per Post - No signs should be mounted on the REVERSE side if the sign in question interferes with either the interpretation or sight line of the regulatory or cautionary sign on front.
- Trees or other natural locations are to be used ONLY when a post is NOT an option and location is CLEARLY visible to the trail.
- All signs should have Property of Club/Trail Group printed on the sign to facilitate prosecution of sign theft or damage.
- These Sign Guidelines apply unless otherwise regulated by law.

SUGGESTED CAUTION AND REGULATORY SIGNS



STOP



STOP AHEAD



BRIDGE HAZARD MARKERS
LEFT RIGHT



SLOW



DIRECTION ARROW



TRAIL CLOSED



TRAIL ENTRY



RAILROAD CROSSING



USE AT YOUR
OWN RISK SIGN

INTERSECTION & STOPS

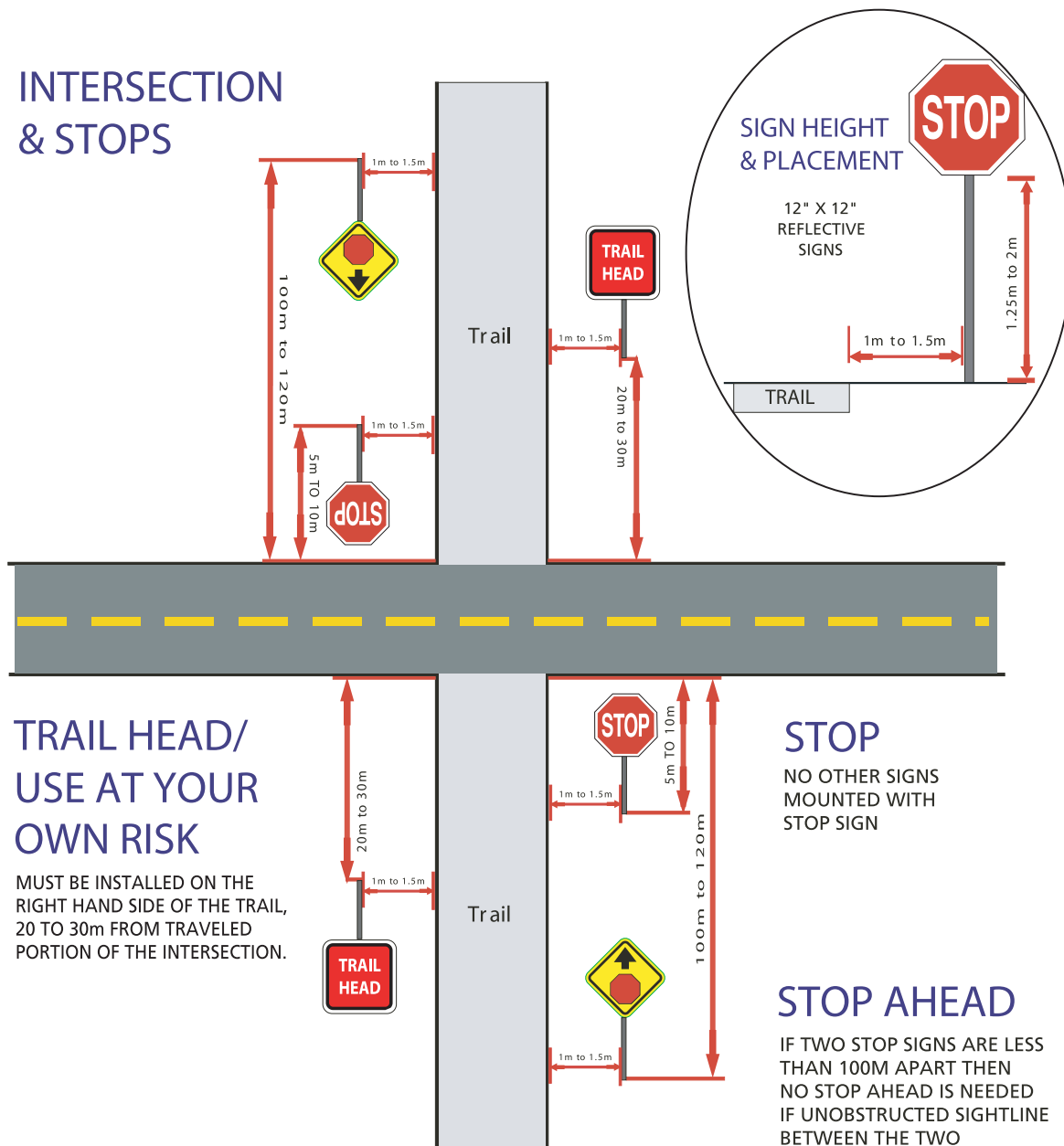

Note: drawings are simulated and not to scale